



DRUM AND LITE DISC MOWERS

REAR

www.samasz.com.au



Over 35 years of experience

The fodder made of grass is one of the best and at the same time the cheapest nourishment for livestock. By using the proper equipment it is possible to reach the swath, which can be easily processed to very nutritious fodder for cows.

SaMASZ agricultural machines are the guarantee of reaching the most valuable fodder from the mowed area. The solutions used in our machines have been developed by SaMASZ engineers for more than 35 years. For a long time they have been one of the most desired equipment, sought all over the world, because owing to them the fodder will suffice for longer time. It happens, because we have developed the whole technological process of harvest in the slightest detail.



TABLE OF CONTENTS

Rear 2-drum mowers

LiteCUT cutterbar

Samba disc mowers



Rear 2-drum mowers

Z 010/1, Z 010/2

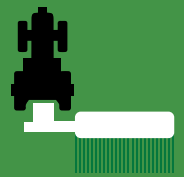

Drum mowers 1,65 m (5'5") to 2,10 m (6'11") have solid design and are very durable. Tough, resistant gearbox is the most essential part of all our mowers.

Special mowing drums transport cut material and lay it down into a smooth swath.



Z 010



Z 010/1H

Thanks to hydraulic lifting (optional equipment), mower can be easily transported at the rear or side of the tractor.

Advantages:

- Genius invention of 20th century - cuts perfectly either lying grass or very high sedge - cane,
- Factory set 5,8 cm (2") cutting height, regulated by distance rings,
- DLG Signum Test,
- Solid and tough design,
- Idling running:
 - on PTO shaft (Z 010/2)
 - on pulley (Z 010 and Z 010/1),
- Safety breakaway device,
- Additional knives and mounting lever,
- Ideally fitted to the ground and even working height,
- Safety breakaway device spring with adjustable deflection,
- Quick and easy knife replacement,
- Standard-delivered PTO shaft with holder,
- Low noise and stable operation,
- PTO 540 rpm,
- Adjustable lower pins,
- Solid metal guard with cover,
- Hydraulic lifting system (option).



Economy and precision of mowing...

Z 010/2
View without
safety guards



Mowing drum section overview

Bevel gears

- low-noise and stable operation

Vertical drive shaft

- made of high-class steel
- supported in 5 bearing points
- high stability even in most demanding conditions

Blade holder and blades

straight blade:

- Z 010, Z 010/1 and Z 010/2: 102 mm, made of hardened steel
- quick blade replacement
- additional blade holder mounting holes

Sliding disc

- strong and durable design - 5 mm / 0.2" thick
- made of wear and abrasion resistant steel

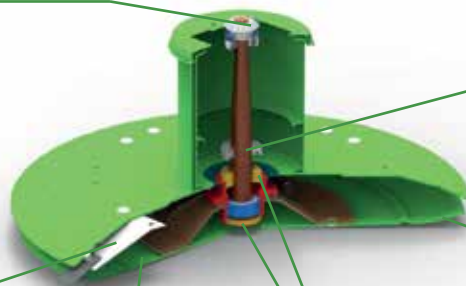

Cutting height adjustment

- with distance rings

2 double-row ball bearings

- durability and extended life

Typ	Working width [m / ft]	Swath width [m / ft]	Working capacity [ha/h / ac/h]	Number of knives [pcs.]	Power demand [HP]	RPM	Dimensions w / l / h [ft]	Weight [kg / lbs]
Z 010/1	1,85 / 6'1"	0,80 / 2'7"	~ 2,00 / 5	6	from 60	540	12,20 / 5,30 / 3,35	455 / 1005
Z 010/2	2,10 / 6'11"	0,90 / 2'11"	~ 2,50 / 6,2	8	from 70		13,45 / 5,75 / 3,50	555 / 1225

Precise CUTTING

Cutterbar

LiteCUT

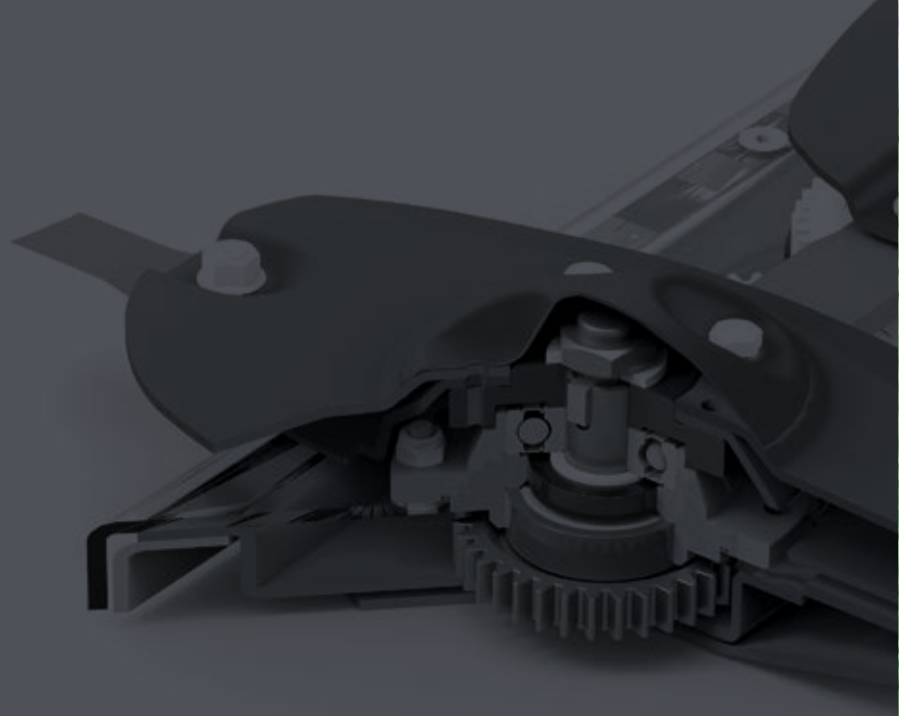

New LiteCUT cutterbar is another model of the cutterbar installed in lightweight mowers - SAMBA. Designed for operation on smaller farms and on hilly and swamp areas. Completely new design provides reliability, high durability and precise cutting line, and all that with reduced power demand.

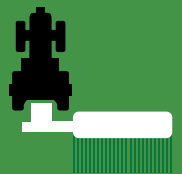

Design

- lightweight, durable, bolted
- thick, 5 mm / 13/64" steel shell



Disc module with **safeGEAR** system

- additional protection for gears inside the cutterbar
- strong, sealed bearings
- quick and easy module replacement even in the field
- reusable after key replacement



Hardened gearbox slide

- cutterbar's drive protection



safeGEAR protection system

- sheared key safety feature as standard

Central knife holder

- improved shape of the holder enables thorough cleaning of the cutterbar
- made of high quality hardened steel
- 360* range of rotation
- quick and easy replacement

Gears - 18 mm thickness

- precisely ground and fitted enable ideal drive transmission and silent work
- protected by **safeGEAR** system
- set on closed 2RS bearings

Sliding skid

- hardened,
- extend machine's life,
- easy to replace



Hardened knives (L=105 mm / 4 9/64")

- SaMASZ logo proves the highest quality,
- quick knife replacement mounting with special lever at the back side and front of the cutterbar





Disc mowers with LiteCUT cutterbar

Samba 240, Samba 280

LiteCUT

Rear, lightweight disc mower SAMBA with working widths from 2.40 up to 2.80 m is designed to operate on smaller farms. Mower works well in hilly as well as swamp areas, where machines and tractors weight is of

great importance. The use of modernized pressure relief system allows for optimal ground pressure adjustment.

Advantages of Samba mowers:

- light design,
- lower power demand with comparable alternative drum mower,
- new LiteCUT cutterbar,
- regulated rear and front guards significantly facilitate replacement of cutting knives,
- rubber swath guides resistant to windin-up when operating in higher grass (option),
- setting up: the transport, operating or rest positions by means of hydraulic cylinder.



SAMBA mowers equipped with SaMASZ LiteCUT cutterbar features, quick knife replacement system, hardened discs and slides, central knife holder and strengthened load-bearing bushings. In addition, central knife holders design has a great influence on cleaning the cutterbar.

		SAMBA 240	SAMBA 280
TECHNICAL DETAILS	Working width [m/ft]	2,40 / 7'11"	2,80 / 9'2"
	Transport width / height [m/ft]	1,70 / 2,90 // 5'7" / 9'6"	1,70 / 3,30 // 5'7" / 10'10"
	Swath width [m/ft]	1,10 - 1,80 / 3'7"- 5'11"	1,50 - 2,20 / 4'11"- 7'3"
	Necessary hydraulic couplers	1 x single acting	
	Working capacity [ha/h // ac/h]	~ 2,50 / ~ 6,20	~ 3,00 / ~ 7,00
	Number of discs [pcs.] Number of knives [pcs.]	6 / 12	7 / 14
	RPM	540	
	3-point hitch cat.	II	
	Power demand [HP]	from 45	from 60
	Weight [kg / lbs]	490 / 1080	505 / 1115
PTO shaft	tractor - mower: with poverrunning clutch		

IMPORTED BY:



COLAC AG

FARM MACHINERY IMPORTERS

colacag.com.au

400 Princes Hwy, Colac West, Vic,
Australia 3249

+61 (0)3 5231 6999

True passion and constant seeking of the best solutions are amongst the ideas, which have been essential for the SaMASZ employees and have become the key to the company's success.

What contributes the most to constant and dynamic development of the company are close contact with our customers and staying open to their needs. Thanks to dialogue with our present and future clients and trying to meet their expectations we create and strengthen up the basis of our dynamic success. We are creating the brand, which is already well recognized not only in the whole Europe, but also in the world.

Considering constant development as our top priority, we invest in product research. Our employees are the most talented Technical University graduates, who are not only experts in their own fields, but also bring in a great dose of professionalism and passion to their duties. You can always count on their competence and reliability.

Your dealer:

Today, SaMASZ is the top Polish and one of the major European manufacturers of forage machinery. Our offer includes more than 300 types of different machines: drum mowers, disc mowers, tedders, rakes, flail mowers, extension arms or snow plows. Since the beginning we managed to manufacture and sell more than 110 000 mowers and few thousands of other machines. We export to more than 50 countries around the world. Our sales network includes approx. 60 companies in Poland and approx. 70 abroad.

Our main goal, which is constant development and implementation to our production cutting edge technology in order to keep the world's top quality. We are fully aware, that in this ever changing reality, customers tend to seek trading partners who are trustworthy, and therefore we have an ambition of being considered as a reliable and professional manufacturer.



Technical data and equipment provided herein, as well as images of the products may be different due to constant technical development.